

**Find Your Place To
Gather, Grow, Give, & Go**



**Crossroads
BAPTIST CHURCH**



 **livestream**

/gocrossroads

crossroadsbaptist.com

3001 Country Club Dr.

Valdosta, GA 31602

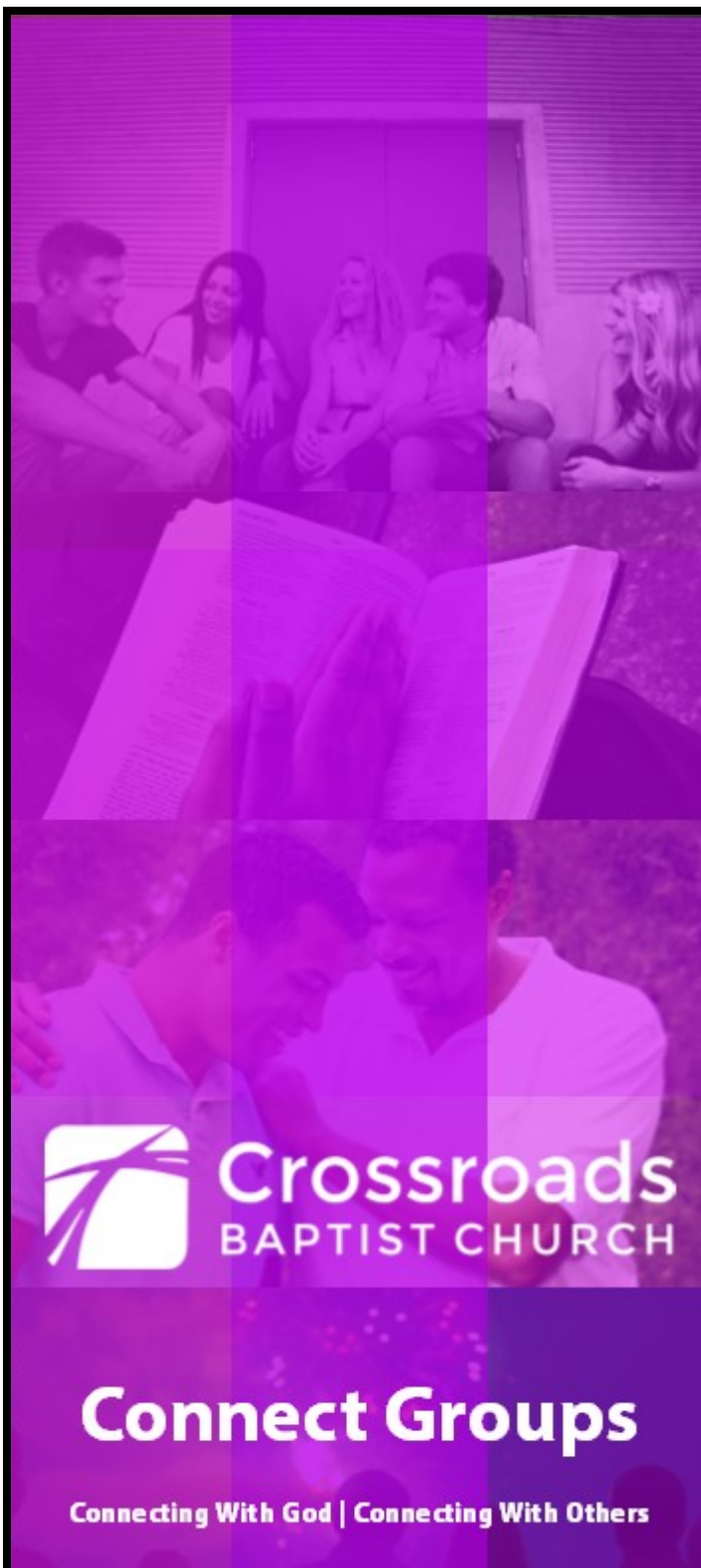

**Crossroads
BAPTIST CHURCH**

Connect Groups

Connecting With God | Connecting With Others

A Note About Connect Groups At Crossroads Baptist

We believe that our Connect Groups are where the big church becomes small! We want you to connect with God and also connect with others during this time. Connect Groups are a great opportunity for you to dive deeper into relationships and God's Word.

We believe that God has created us to first have a relationship with Him, then a relationship with others. As Christians, we need other Christians to stand alongside us and encourage us to live for Him. During the Connect Group time, we encourage you to grow in Christ through studying God's Word and applying it practically to your daily lives.

We believe there is a Connect Group for everyone! We offer groups both at 9:00 a.m. and at 10:30 a.m. so that you may worship at one time and join a Connect Group during the other. If you have children, check out the wonderful groups we have available. Come and be a part of our family and be encouraged to grow in Christ!



Jamie Warnshuis
Children & Families Pastor

Crossroads KIDS

PRESCHOOL (Birth—Kindergarten)

We have a ministry for your child during both the 9 a.m. and 10:30 a.m. hours which allows you to attend worship and a Connect Group. We provide an atmosphere where your child will be loved and taught about Jesus! You will be given a beeper when you sign-in your child.

9:00 a.m. - 12:00 p.m.

Babies	Nursery
Crawlers	Nursery
Ones	Nursery
Twos	Fellowship Hall—107
Threes	Fellowship Hall—101
Fours	Fellowship Hall—104
Kindergarten	School—205

During the 10:30 a.m. hour, we combine the fours and kindergarten for a time called Crossroads Kids J.A.M. (Jesus And Me). During this time, they will worship, pray, be taught a Bible story, and more!

CHILDREN (1st-5th Grades)

We encourage families to worship together on Sunday mornings. We provide classes for children during both hours so that you can get involved with a Connect Group as well.

9:00 a.m.

1st-5th Grade	School—203
----------------------	------------

10:30 a.m.

1st Grade	School—203
2nd Grade	Barn—406
3rd Grade	Barn—405
4th Grade	Barn—404
5th Grade	Barn—403



YOUTH

10:30 a.m.
 Students in grade 6 through 12 initially meet in The Connection for fresh doughnuts and sweet tea. Following this time, students divide into Connect Groups based on aged and gender. These youth small groups cover topics that are relevant to their stage of life!



9:15 a.m.
 College-age students are welcome to connect with others and grow together in the Lord. This Connect Group meets in **The Connection**. Each lesson is timely and developed for college-age students.

CAMPUS MAP

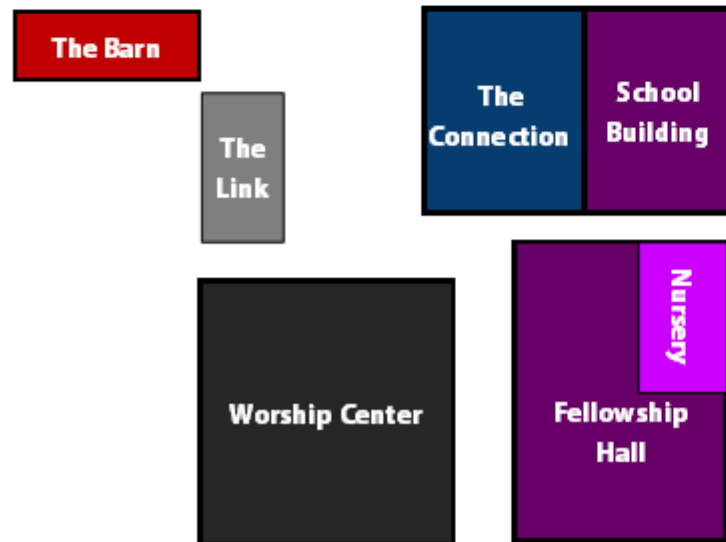

ADULTS

Each of our adult Connect Groups provide a great place for you to fellowship and study God's Word together. Connect Groups are generally organized by aged & stage of life.

- 9:00 a.m.**
- Young Singles** The Barn—401
Matt Gay
 - Coed 50-64** Fellowship Hall—111
Tyson McLane & Roy Rhodes
 - Faith Keepers** Fellowship Hall—112
Danny Helms *Coed 65+*

- 10:30 a.m.**
- Nearly/Newly Weds** The Link —Room 1
Jeff & Beth Ford
Jody & Christie Allen
 - Young Marrieds** The Link —Room 3
Rhett Pickle
 - Ladies** Fellowship Hall—108
Pat Denmark & Laura Howard
 - Coed 30-50** The Link —Room 2
Britt McLane
 - Coed 35-50** Fellowship Hall—112
Stuart Hasty
 - Coed 38-50** Fellowship Hall—111
Dave Washabaugh
 - Coed 50-60** Fellowship Hall—110
Chuck Rigoni
 - Coed 60+** Fellowship Hall—106
Len Harvey